

## 1/4" 12,500 psi High pressure ChemJec hose 2440M-04V38

**CONSTRUCTION**

Core tube . . . . .Fluoropolymer based core tube  
Pressure reinforcement . . . . .High strength wire

Cover . . . . .PA12  
Colour . . . . .Golden

**TEMPERATURE RANGE**

-40°C up to +110°C  
-40°F up to +230°F  
For higher temperature requirements please contact Polyflex Division

**MAX. LENGTH**

3,750 m / 12,303 ft  
(for longer length requirements please contact Parker Hannifin)

**SPECIFICATION**

Meets or exceeds performance requirements of ISO 13628-5 / API 17E

**2440M-04V38**

mm		inch		MPa		psi		mm		inch		kg/m		lbs/ft		Collapse pressure		DF
6.5	1/4	13.1	0.520	87.5	12,688	350	50,750	150	5.9	0.31	0.21	31.8	4,495	4.0				

**JIC female swivel****Material: AISI 316 / 316Ti**

#		A		B		H	
		mm	inch	mm	inch	mm	psi
1068X-6-04C	9/16 - 18 UNF	55.0	2.165	24.0	0.945	19	15,000

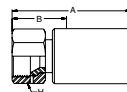
**Type M female swivel****Material: AISI 316 / 316Ti**

#		A		B		J	
		mm	inch	mm	inch	mm	psi
1AY8X-6-04C	9/16 - 18 UNF	66.0	2.598	33.0	1.300	19	15,000

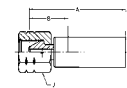
**Medium pressure tube nipple****Material: AISI 316 / 316Ti**

#		A		B			
		mm	inch	mm	inch	MPa	psi
1Y28X-6-04C	3/8 - 24 UNF - LH	120.0	4.724	87.0	3.425	138.0	20,000

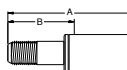

**HIGH PRESSURE WIRE HOSES CHEMJEC**

**5/16" 10,000 psi High pressure ChemJec hose  
2440M-05V38**



**C**

- CONSTRUCTION**
  - Core tube . . . . .Fluoropolymer based core tube
  - Pressure reinforcement . . . . .High strength wire
  - Cover . . . . .PA12
  - Colour . . . . .Golden
- TEMPERATURE RANGE**
  - 40°C up to +125°C
  - 40°F up to +257°F
  - For higher temperature requirements please contact Polyflex Division
- MAX. LENGTH**
  - 4,000 m / 13,123 ft
  - (for longer length requirements please contact Parker Hannifin)
- SPECIFICATION**
  - Meets or exceeds performance requirements of ISO 13628-5 / API 17E

**2440M-05V38**

Ø		Ø		↗		↗		↗		⊞		Collapse pressure		DF
mm	inch	mm	inch	MPa	psi	MPa	psi	mm	inch	kg/m	lbs/ft	MPa	psi	
8.3	5/16	16.2	0.637	69	10,000	276.0	40,000	175	6.9	0.49	0.33	26	3,771	4.0

**JIC female swivel**

**Material: AISI 316 / 316Ti**

#	↗	A		B		⊞	↗	
		mm	inch	mm	inch		mm	MPa
106LX-6-05C	9/16 - 18 UNF	78.0	3.07	33.0	1.30		69.0	10,000

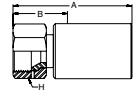

**BSP female swivel (60° cone)**

**Material: AISI 316 / 316Ti**

#	↗	A	B	⊞	↗	
		mm	mm		mm	MPa
192LX-6-05C	G 3/8	69.0	25.0	27	150.0	21,750

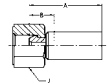

**Type M female swivel**

**Material: AISI 316 / 316Ti**

#	↗	A	B	⊞	↗	
		mm	mm		mm	MPa
1AYLX-8-05C	3/4 - 16 UNF	70.0	31.0	27	150.0	21,750

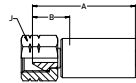

## 3/8" 10,000 psi High pressure ChemJec hose 2440M-06V38

**CONSTRUCTION**

Core tube . . . . .Fluoropolymer based core tube  
Pressure reinforcement . . . . .High strength wire

Cover . . . . .PA12  
Colour . . . . .Golden

**TEMPERATURE RANGE**

-40°C up to +110°C  
-40°F up to +230°F  
For higher temperature requirements please contact Polyflex Division

**MAX. LENGTH**

2,600 m / 8,530 ft  
(for longer length requirements please contact Parker Hannifin)

**SPECIFICATION**

Meets or exceeds performance requirements of ISO 13628-5 / API 17E

**2440M-06V38**

												Collapse pressure		DF
mm	inch	mm	inch	MPa	psi	MPa	psi	mm	inch	kg/m	lbs/ft	MPa	psi	
9.9	3/8	19.5	0.770	69	10,000	276.0	40,000	190	7.5	0.73	0.49	30	4,350	4.0

**JIC female swivel****Material: Special Stainless Steel Materials**

#		A		B				
		mm	inch	mm	inch		mm	MPa
106LX-6-06C-M-Subsea	9/16 - 18 UNF	87.0	3.43	34.0	1.34	19	69.0	10,000
106LX-8-06C-M-Subsea	3/4 - 16 UNF	87.0	3.43	34.0	1.34	24	69.0	10,000

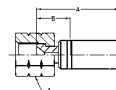
**Medium pressure tube nipple****Material: Special Stainless Steel Materials**

#		A		B			
		mm	inch	mm	inch	MPa	psi
1Y2LX-9-06C-M-SUBSEA	9/16 - 18 UNF - LH	158.0	6.22	105.0	4.13	138.0	20,000

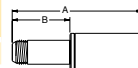

**HIGH PRESSURE WIRE HOSES CHEMJEC**

**1/2" 10,000 psi High pressure ChemJec hose  
2440M-08V38**



- CONSTRUCTION**
  - Core tube . . . . .Fluoropolymer based core tube
  - Pressure reinforcement . . . . .High strength wire
  - Cover . . . . .PA12
  - Colour . . . . .Golden
- TEMPERATURE RANGE**
  - 40°C up to +100°C
  - 40°F up to +212°F
  - For higher temperature requirements please contact Polyflex Division
- MAX. LENGTH**
  - 4,500 m / 14,764 ft
  - (for longer length requirements please contact Parker Hannifin)
- SPECIFICATION**
  - Meets or exceeds performance requirements of ISO 13628-5 / API 17E

**2440M-08V38**

mm		inch		MPa		psi		mm		inch		kg/m		Collapse pressure		DF
12.9	1/2	22.7	0.890	69	10,000	276.0	40,000	200	7.9	0.94	0.63	25.2	3,654	4.0		

**JIC female swivel**

**Material: Special Stainless Steel Materials**

#	mm	inch	A		B		mm	MPa	psi
			mm	inch	mm	inch			
106LX-8-08C-M-Subsea	3/4 - 16 UNF	100.0	3.94	35.0	1.38	24	69.0	10,000	

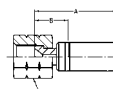

**Medium pressure tube nipple**

**Material: Special Stainless Steel Materials**

#	mm	inch	A		B		mm	MPa	psi
			mm	inch	mm	inch			
1Y2LX-12-08C-M-SUBSEA	3/4 - 16 UNF - LH	184.2	7.25	119.4	4.70	138.0	20,000		

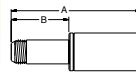

## 3/4" 10,000 psi High pressure ChemJec hose 2440M-12V38

**CONSTRUCTION**

Core tube . . . . .Fluoropolymer based core tube

Pressure reinforcement . . . . .High strength wire

Cover . . . . .PA12

Colour . . . . .Golden

**TEMPERATURE RANGE**

-40°C up to +110°C

-40°F up to +230°F

For higher temperature requirements please contact Polyflex Division

**MAX. LENGTH**

2,300 m / 7,546 ft

(for longer length requirements please contact Parker Hannifin)

**SPECIFICATION**

Meets or exceeds performance requirements of ISO 13628-5 / API 17E

**2440M-12V38**

mm		inch		MPa		psi		mm		inch		kg/m		lbs/ft		Collapse pressure		DF
20.2	3/4	30.2	1.190	69	10,000	250.0	36,250	250	9.8	1.46	0.98	11	1,595	36.0				

**JIC female swivel****Material: Special Stainless Steel Materials**

#	mm	inch	A		B		mm	MPa	psi
			mm	inch	mm	inch			
106LX-16-12C4462	1 5/16 - 12 UNF		99.0	3.9	43.0	1.69	41	69.0	10,000

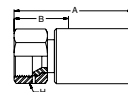
**Medium pressure tube nipple****Material: Special Stainless Steel Materials**

#	mm	inch	A		B		MPa	psi
			mm	inch	mm	inch		
1Y2LX-12-12C4462	3/4 - 16 UNF - LH		160.0		100.0		137.9	20,000
1Y2LX-16-12C4462	1 - 14 UNS - LH		181.0	7.13	119.4	4.70	138.0	20,000

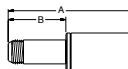
**Type M female swivel****Material: Special Stainless Steel Materials**

#	mm	inch	A		B		mm	MPa	psi
			mm	inch	mm	inch			
1AYLX-16-12C4462	1 5/16 - 12 UNF		92.0	3.62	38.0	1.49	41	103.5	15,000

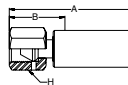

# 1" 5,000 psi High pressure ChemJec hose

## 2440M-16V38-5K

**CONSTRUCTION**

Core tube . . . . .Fluoropolymer based core tube  
 Pressure reinforcement . . . . .High strength wire

Cover . . . . .PA12  
 Colour . . . . .Golden

**TEMPERATURE RANGE**

-40°C up to +125°C  
 -40°F up to +257°F  
 For higher temperature requirements please contact Polyflex Division

**MAX. LENGTH**

2,000 m / 6,562 ft  
 (for longer length requirements please contact Parker Hannifin)

**SPECIFICATION**

Meets or exceeds performance requirements of ISO 13628-5 / API 17E

**2440M-16V38-5K**

mm		inch		MPa		psi		mm		inch		kg/m		lbs/ft		Collapse pressure		DF
25.2	1	37.2	1.460	34.5	5,000	225.0	32,625	300	11.8	2.05	1.36	6.5	943	65.0				

**JIC female swivel****Material: Special Stainless Steel Materials**

#	mm	inch	A		B		H	Pressure	
			mm	inch	mm	inch		MPa	psi
106LX-16-16C4462	1 5/16 - 12 UNF		77.0	3.03	25.5	1.00	41	34.5	5,000

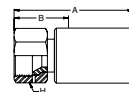
**Medium pressure tube nipple****Material: Special Stainless Steel Materials**

#	mm	inch	A		B		Pressure	
			mm	inch	mm	inch	MPa	psi
1Y2LX-16-16C4462	1 - 14 UNS - LH		181.0	7.13	127.0	5.00	138.0	20,000

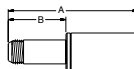
**Metric female swivel heavy series with O-ring****Material: Special Stainless Steel Materials**

#	mm	inch	A		B		H	Pressure	
			mm	inch	mm	inch		MPa	psi
1C9LX-30-16C4462	M42x2		99.0	3.90	45.0	1.77	50	90.0	13,050

